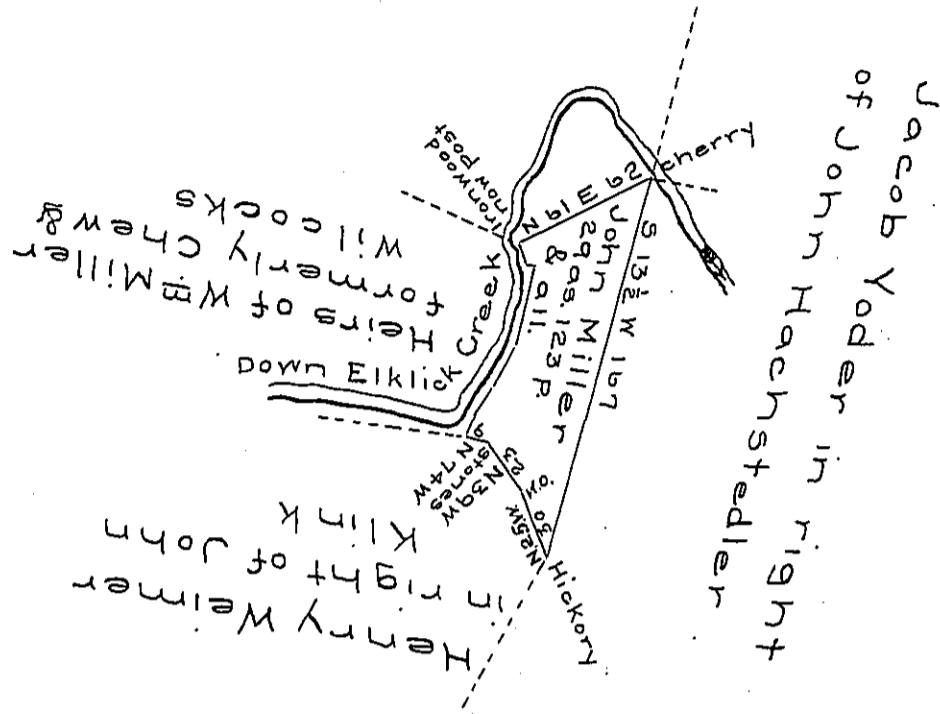

Table of courses Down
the Creek.

- N 22 E 12 p.
- N 37 E 11 "
- N 29 E 20 "
- N 9 E 39 to a rock
- West 35 p. to a w.o.
- N 22½ W 9.7 p to an
Iron wood.



Daniel & Samuel Millers other land situate on the hill south east of the Elk Lick also of the Elklick creek in Summit formerly Elklick township Somerset County and surveyed the 25th day of February A.D. 1820 by Douglas Baker in pursuance of a warrant dated the 21st day of December A.D. 1819 granted to the said John Miller for thirty acres, & resurveyed this 7th day of Sept. A.D. 1853, ^{certified} & returned the 19th day of Dec. A.D. 1853.

To J. Porter Brawley Esq }
Surveyor General of }
Pennsylvania }

pr. Martin Meyer Dep.
surveyor of S. Co.

IN TESTIMONY that the above is a copy of the original remaining on file in the Department of Internal Affairs of Pennsylvania, made conformably to an Act of Assembly approved the 16th day of February, 1833, I have hereunto set my Hand and caused the Seal of said Department to be affixed at Harrisburg, this seventh day of May 1906

George R. ...
Secretary of Internal Affairs.